

MVGL-ID5307-08SWN

6 MP Smart Code Reader



Introduction

With mechanical autofocus lens, MVGL-ID5307-08SWN smart code reader can read different types of 1-dimensional and 2-dimensional codes with reading speed up to 90 codes/s. It adopts Hikrobot's deep learning algorithm to process image with good robustness, and can recognize various complex barcodes.

Key Feature

- Adopts built-in deep learning algorithm to read barcodes with good robustness.
- Adopts mechanical autofocus lens to achieve automatic focusing.
- Adopts multiple IO interfaces for input and output.
- Supports multiple communication protocols, including TCP/IP, Serial, FTP, HTTP, etc.
- Adopts CMOS sensor to acquire image data and provide high-quality image.
- Supports RS-232 serial port and indicators displaying device status.

Available Model

Smart code reader with 8 mm focal length:
MVGL-ID5307-08SWN

Applicable Industry

Consumer electronics, food and beverage, pharmaceutical, semiconductor, automobile, etc.

Dimension

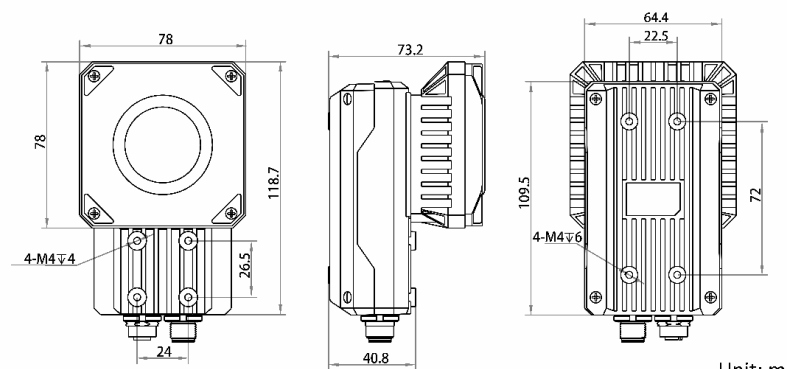

Unit: mm



Specification

Model	MVGL-ID5307-08SWN
Performance	
Symbologies	1-dimensional codes: Code 39, Code 93, Code 128, ITF25, CodaBar, EAN 2-dimensional codes: QR, Data Matrix
Max. frame rate	30 fps
Max. reading speed	90 codes/sec
Sensor type	CMOS, rolling shutter
Pixel size	2.4 μm \times 2.4 μm
Sensor size	1/1.8"
Resolution	3072 \times 2048
Exposure time	16 μs to 1 sec
Gain	0 dB to 40 dB
Mono/color	Mono
Communication protocol	SmartSDK, TCP Client, TCP Server, Serial, FTP, HTTP, UDP
Electrical features	
Data interface	Gigabit Ethernet
Digital IO	12-pin M12 connector provides power and I/O, including opto-isolated input (LineIn 0/1/2) \times 3, opto-isolated output (LineOut 0/1/2) \times 3, RS-232 input \times 1, and RS-232 output \times 1.
Power supply	24 VDC
Power consumption	Approx. 20 W@24 VDC (light source is enabled)
Mechanical	
Lens focal length	8 mm (0.3")
Lens mount	M12-mount, mechanical autofocus lens.
Lens cap	Transparent lens cap. Polarization lens cap is optional.
Light source	White light. Red or blue light is optional.
Indicator	Power indicator (PWR), network indicator (LNK/ACT), and user indicator (U1/U2).
Dimension	118.7 mm \times 78 mm \times 73.2 mm (4.7" \times 3.1" \times 2.9")
Weight	Approx. 520 g (1.1 lb.)
Ingress protection	IP67 (under proper installation of waterproof lens cap)
Temperature	Working temperature: 0 $^{\circ}\text{C}$ to 50 $^{\circ}\text{C}$ (32 $^{\circ}\text{F}$ to 122 $^{\circ}\text{F}$) Storage temperature: -30 $^{\circ}\text{C}$ to 70 $^{\circ}\text{C}$ (-22 $^{\circ}\text{F}$ to 158 $^{\circ}\text{F}$)
Humidity	20% to 95% RH, non-condensing
General	
Client software	IDMVS
Certifications	CE, FCC

HIKROBOT

Hangzhou Hikrobot Technology Co., Ltd.
No.399 Danfeng Road, Binjiang District, Hangzhou 310051, China.
en.hikrobotics.com

Copyright Hikrobot

Hangzhou Hikrobot Technology Co., Ltd. All Rights Reserved. Hangzhou Hikrobot Technology does not tolerate any infringement. Any organization or individual may not imitate or reproduce in whole or in part of the content. The data herein is based on Hikrobot's internal evaluation. Actual data may vary depending on specific configuration and operating condition. The information herein is subject to change without notice. All the content has been checked conscientiously. Nevertheless, Hikrobot shall not be liable to damages resulting from errors, inconsistencies or omissions.